

DATE OF ISSUE

First Draft	12/15/14
Revisions	02/02/15
Revisions	03/07/15
Revisions	05/03/15
Revisions	07/13/15
Revisions	08/11/15
Revisions	08/20/15
Revisions	09/16/15
Revisions	09/17/15
Revisions	04/28/16
Revisions	10/17/16
Revisions	01/20/17
Revisions	02/01/17
Revisions	03/22/17
Revisions	11/20/17

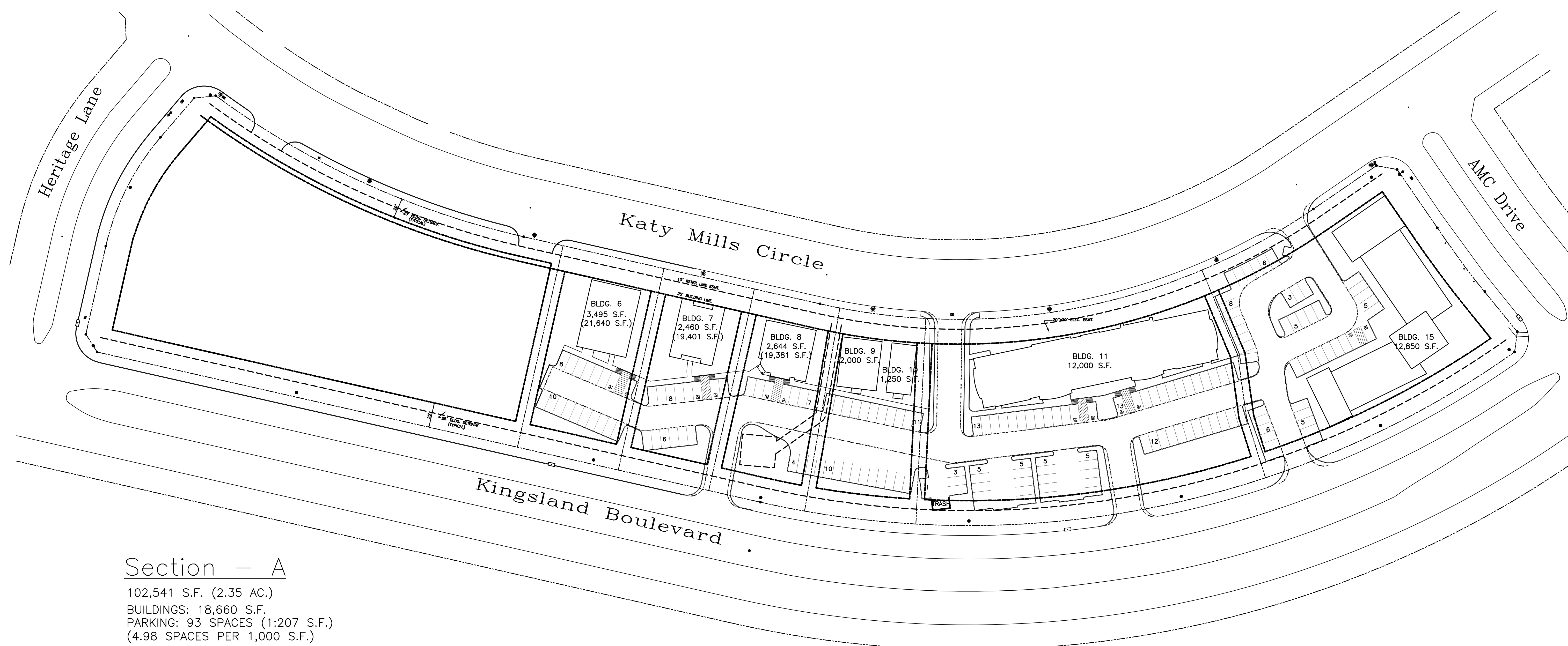

Section - A

102,541 S.F. (2.35 AC.)
 BUILDINGS: 18,660 S.F.
 PARKING: 93 SPACES (1:207 S.F.)
 (4.98 SPACES PER 1,000 S.F.)

Section - B

104,325 S.F. (2.39 AC.)
 BUILDINGS: 18,080 S.F.
 PARKING: 87 SPACES (1:207 S.F.)
 (4.81 SPACES PER 1,000 S.F.)

Section - C

102,501 S.F. (2.42 AC.)
 BUILDINGS: 18,760 S.F.
 PARKING: 87 SPACES (1:215 S.F.)
 (4.63 SPACES PER 1,000 S.F.)

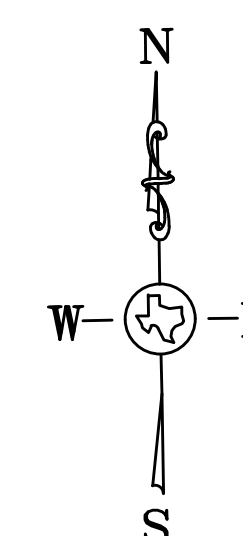

SITE PLAN

SCALE: 1"=50'

NOT FOR CONSTRUCTION
 THIS PLAN IS FOR INFORMATION PURPOSES ONLY

These drawings and specifications are copyrighted; they are and shall remain the sole property of Purser Architectural, Inc. ("Architect") unless otherwise noted. These drawings are not to be used on other projects or extensions to this project except by agreement with appropriate compensation to Architect. Contractor is responsible for confirming and correcting dimensions at job site. Architect will not be responsible for construction means, methods, techniques or procedures or for safety precautions and programs in connection with this project.

PROJECT NUMBER

..

DATE: 11/30/2017

SHEET NUMBER:

A02