

## HENNESSEE BUILDING COMPANY

### KING'S PLACE BUSINESS PARK Katy, TX.

#### DATE OF ISSUE

First Draft	04/14/2016
Revisions	06/20/2016
Revisions	07/05/2016
Revisions	07/27/2016
Revisions	10/07/2016
Revisions	10/12/2016
Revisions	11/02/2016
Revisions	12/09/2016
Revisions	02/15/2017
Revisions	05/15/2017
Revisions	08/21/2017
Revisions	09/13/2017
Revisions	12/20/2017
Revisions	05/17/2018
Revisions	06/22/2018
Revisions	09/14/2018

**NOT FOR CONSTRUCTION**  
THIS PLAN IS FOR INFORMATION PURPOSES ONLY

These drawings and specifications are copyrighted: They are and shall remain the sole property of Purser Architectural, Inc. ("Architect") unless otherwise noted. These drawings are not to be used on other projects or extensions to this project except by agreement with appropriate compensation to Purser Architectural, Inc. Contractor is responsible for confirming and correlating dimensions at job site. Architect will not be responsible for construction means, methods, techniques or procedures or for safety precautions and programs in connection with this project. Reproduction of these drawings is prohibited without permission from Purser Architectural, Inc. These drawings are not valid for construction purposes without seal and signature from licensed architect.

PROJECT NUMBER

----

DATE: 09/18/2018

SHEET NUMBER:

# A02.5

OF: 03

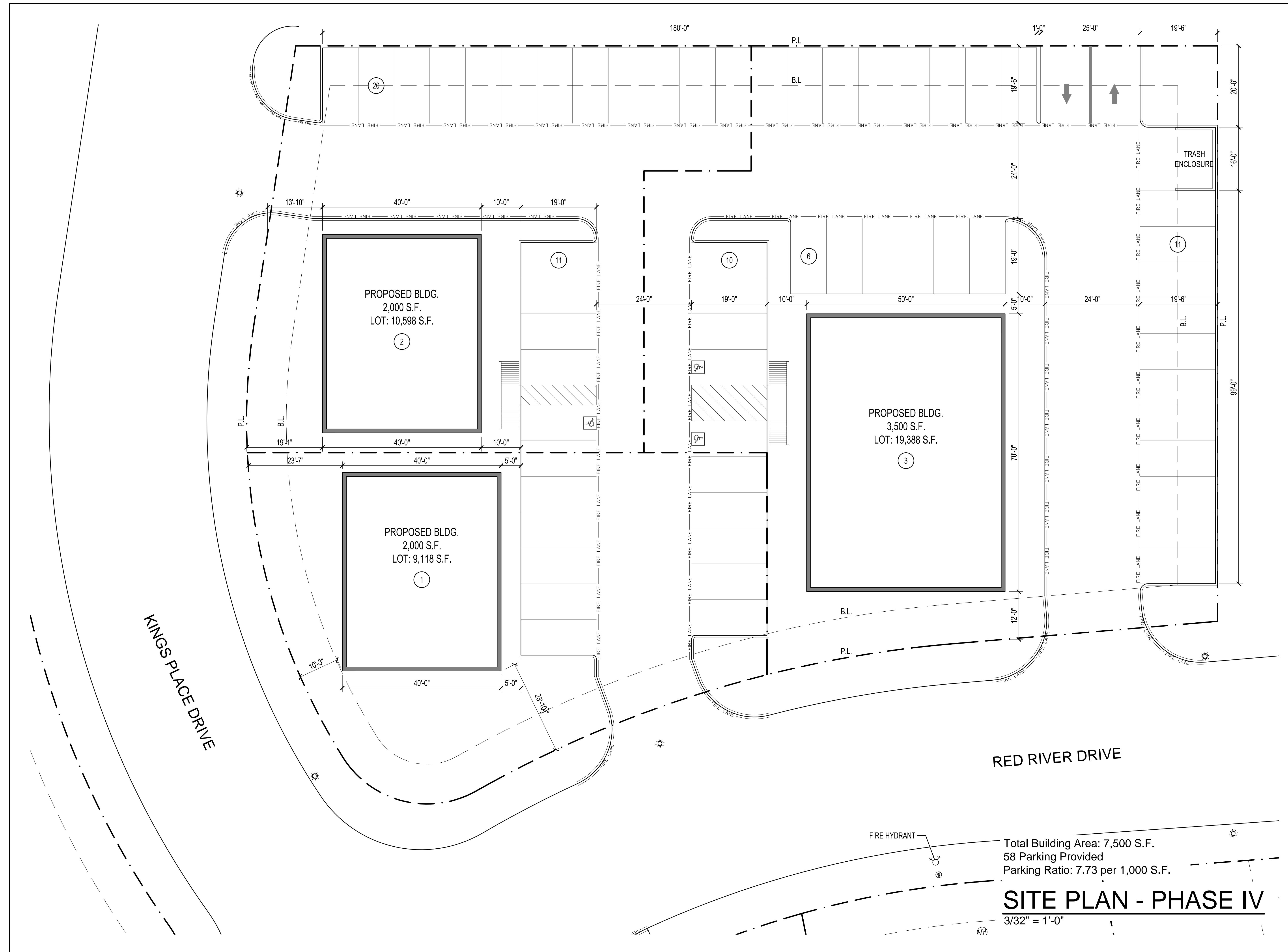

Total Building Area: 7,500 S.F.  
58 Parking Provided  
Parking Ratio: 7.73 per 1,000 S.F.

## SITE PLAN - PHASE IV

3/32" = 1'-0"